



*jordan fishwick*

7 Bollin Court, Macclesfield Road, SK9 2AP  
Asking Price £399,950

## Bollin Court Wilmslow SK9 2AP

Asking Price £399,950



No Chain. Recently redecorated with new flooring and carpets. This spacious second floor two double bedroom apartment is situated in the highly sought after Bollin Court development. Bollin Court is situated off Macclesfield Road and benefits from being a short walk from Wilmslow town centre and the train station, which provides direct connection to London Euston and Manchester Piccadilly. This second floor apartment can be accessed via a communal staircase and also via a lift to all floors. Internally the property requires a degree of modernisation whilst offering well proportioned accommodation throughout. The private and large entrance hallway has storage cupboards and provides access to the following. There is a well proportioned kitchen with fitted kitchen units and several integrated appliances. Separately a spacious living room with windows overlooking the front aspect providing an elevated and leafy view to the communal gardens to the front of the building. Both bedroom one and two are well proportioned with the principal bedroom benefiting from a useful WC (which would make an excellent en suite shower room). Bedroom two has a built-in wardrobe providing additional storage. The bathroom is fitted with a three piece bathroom suite which consists of a bath, wash hand basin and a corner shower enclosure with shower fittings. There is also a separate WC with wash hand basin. Externally the property benefits from having a private garage which has a power supply. The development has immaculately presented communal grounds and the property is sold with No Onward Vendor Chain. Some photos have had digital furniture added to show case the space on offer.



- Second Floor Apartment
- Two Double Bedrooms
- Living Room/Dining Room
- Spacious Accommodation
- Superb location
- Lift access
- Garage & parking
- Beautiful communal grounds
- No Onward Vendor Chain



Energy Efficiency Rating		
	Current	Potential
Very energy efficient - lower running costs		
(92 plus) <b>A</b>		
(81-91) <b>B</b>		<b>86</b>
(69-80) <b>C</b>		
(55-68) <b>D</b>	<b>65</b>	
(39-54) <b>E</b>		
(21-38) <b>F</b>		
(1-20) <b>G</b>		
Not energy efficient - higher running costs		
<b>England &amp; Wales</b>	EU Directive 2002/91/EC	



## GROUND FLOOR

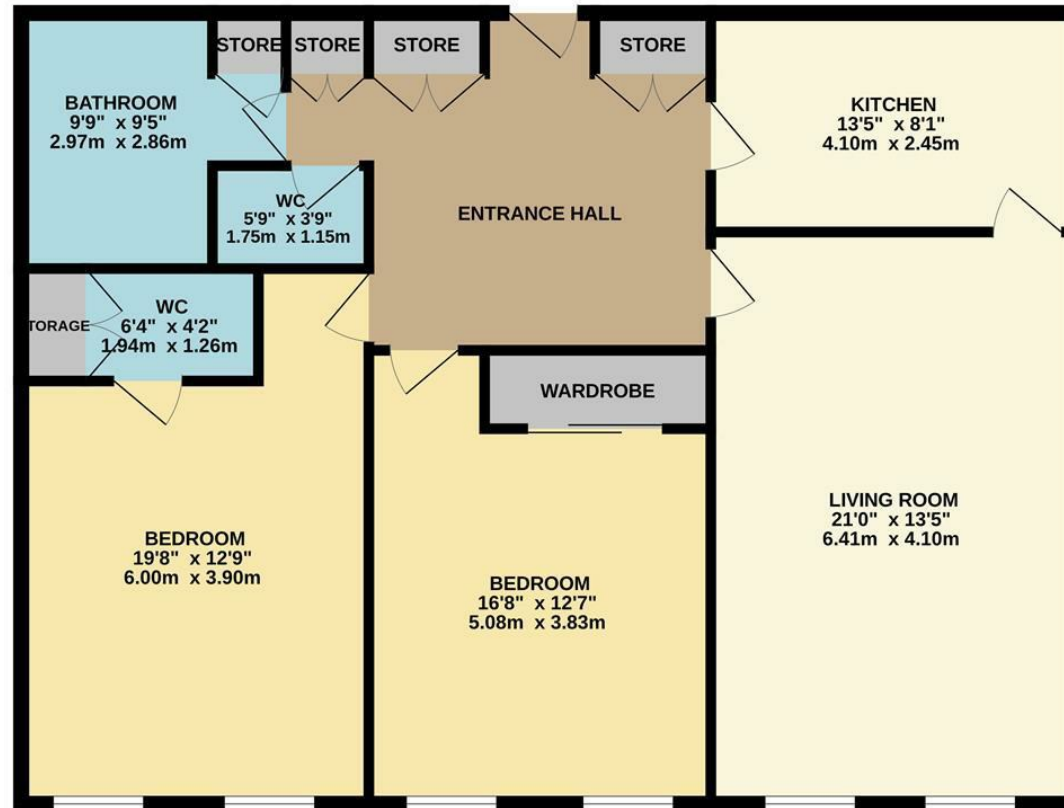

Measurements are approximate. Not to scale. Illustrative purposes only.  
Made with Metropix ©2025.



These particulars are believed to be accurate but they are not guaranteed and do not form a contract. Neither Jordan Fishwick nor the vendor or lessor accept any responsibility in respect of these particulars, which are not intended to be statements or representations of fact and any intending purchaser or lessee must satisfy himself by inspection or otherwise as to the correctness of each of the statements contained in these particulars. Any floorplans on this brochure are for illustrative purposes only and are not necessarily to scale.

Offices at: Chorlton, Didsbury, Disley, Hale, Glossop, Macclesfield, Manchester Deansgate, Manchester Whitworth Street, New Mills, Sale, Wilmslow and Withington

36-38 Alderley Road, Wilmslow SK91JX  
**01625 532000**

wilmslow@jordanfishwick.co.uk  
www.jordanfishwick.co.uk